

### 1 PARTS

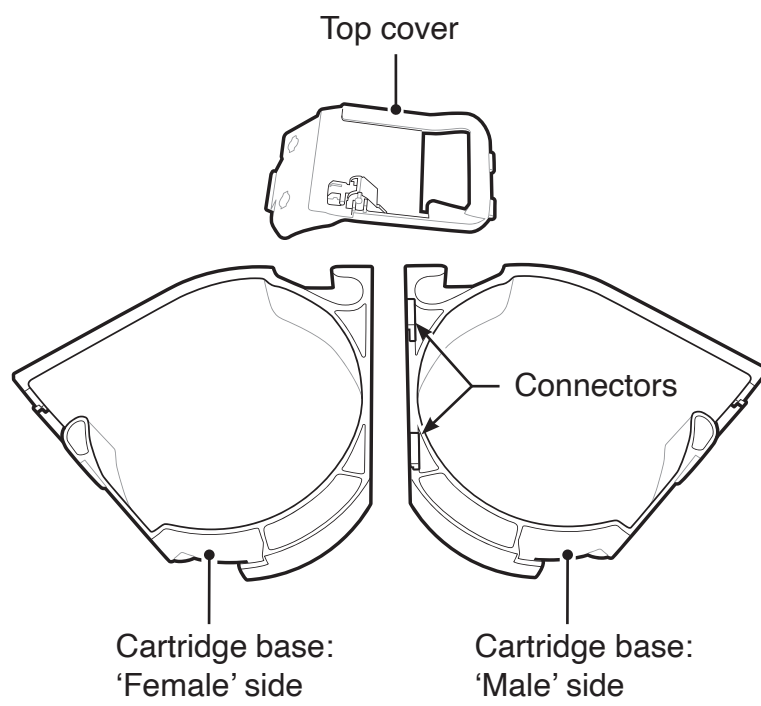

### 2 A Karie cartridge can be filled with no more than 60 PacMed pouches in a strip

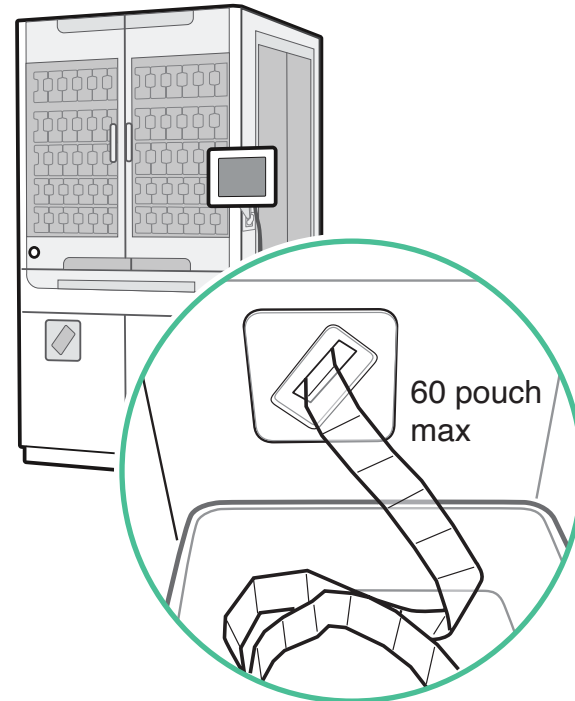

### 3 Rolling the strip: Find the SUMMARY BAG and grip its top edge between two fingers with pouch text facing you

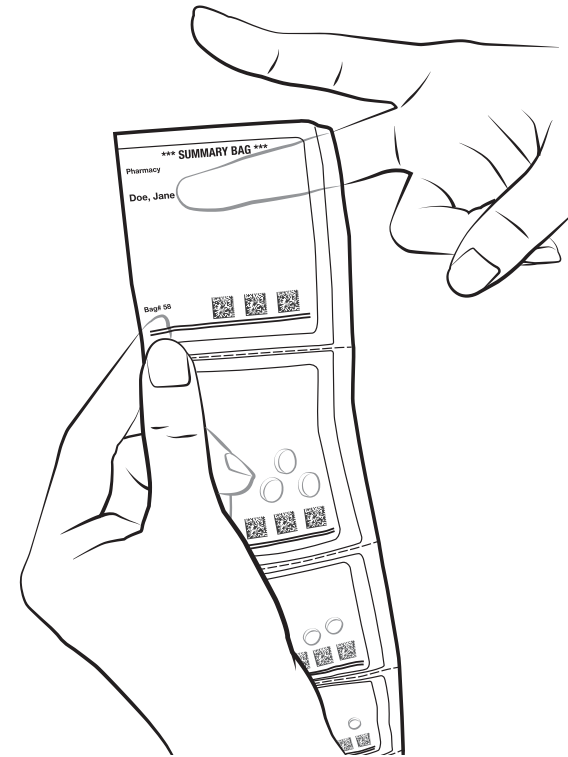

### 4 Roll around both fingers 2-3 times, under loose tension, pouch text facing outward



### 5 Withdrawing fingers from the center should be easy: repeat steps 3-4 if too tight. Do *not* compress while rolling

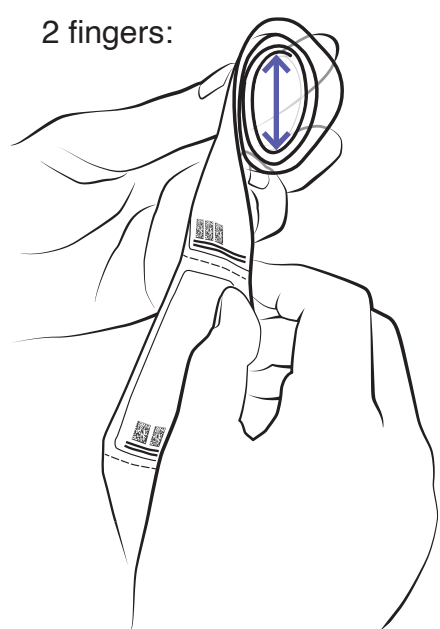

### 6 Rolling technique: rotate your index fingers around each other in the centre to create a roll

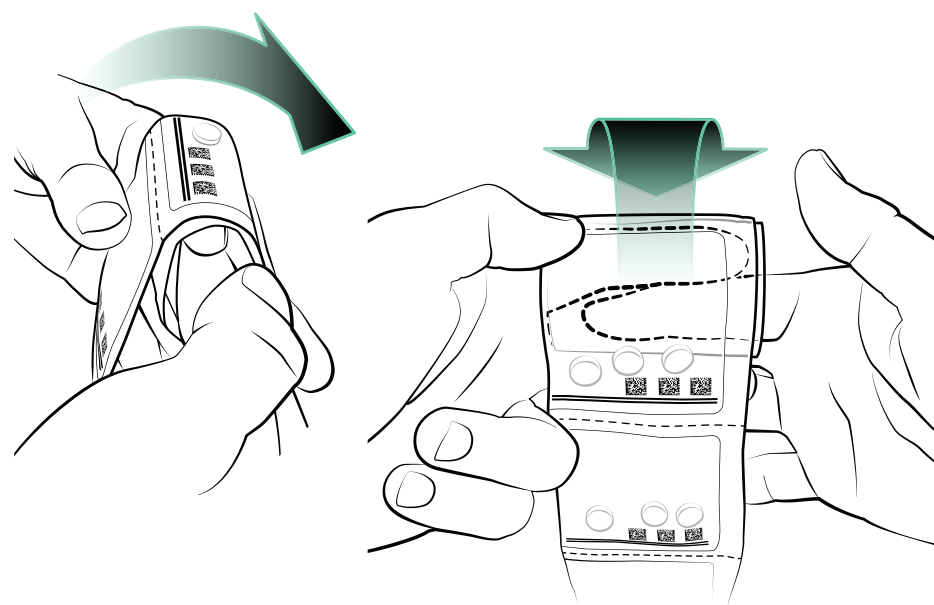

### 7 Locate the first medication pouch and the header pouch. **Remove the header pouch**

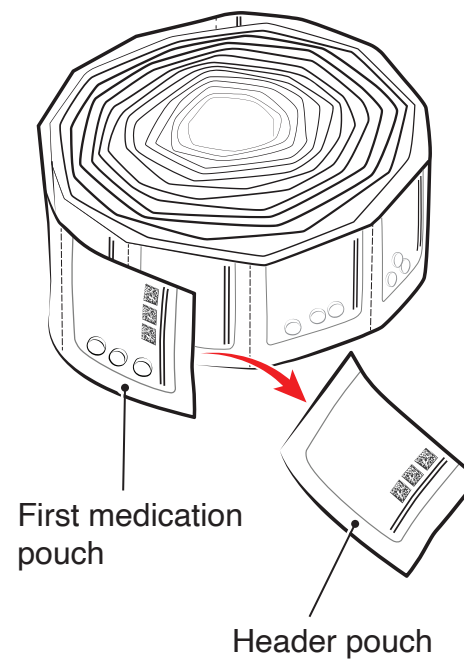

### 8 Place the completed roll in the one side of the cartridge with half of the first medication pouch hanging out the top

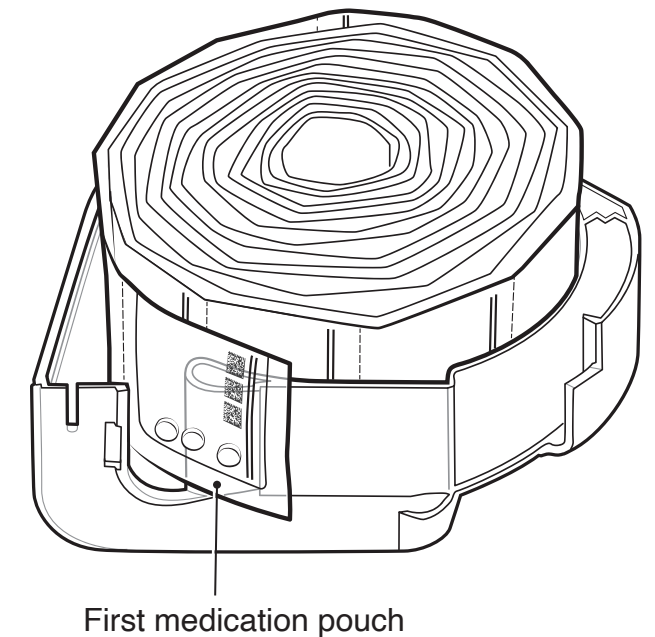

### 9 Align connectors of one side with slots on the other side of the cartridge. Close the sides together like a book

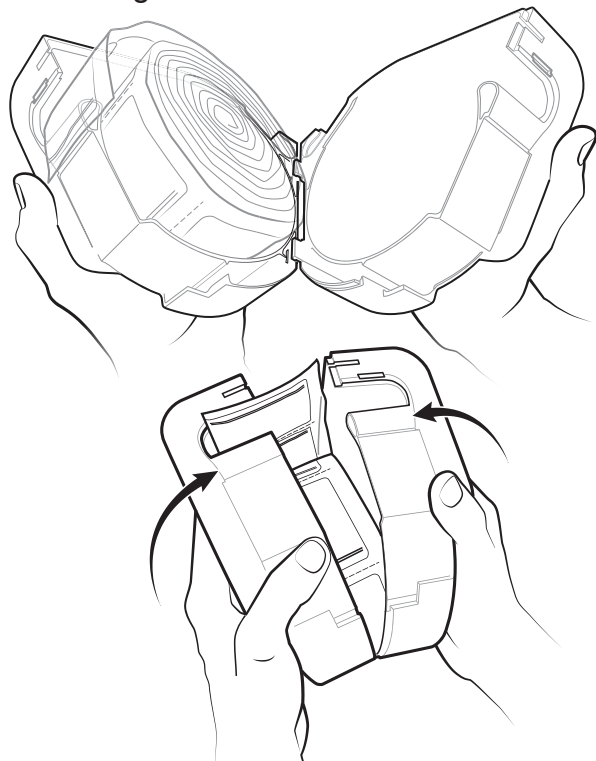

### 10 Cartridge sides assembled together, with medication strip ready for the top cover

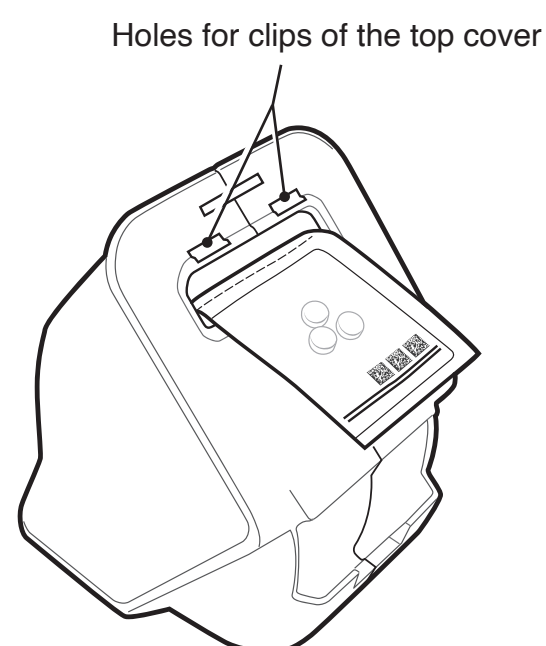

### 11 Guide the header pouch through the opening in the top cover



### 12 Insert the clips of the top cover into their corresponding holes

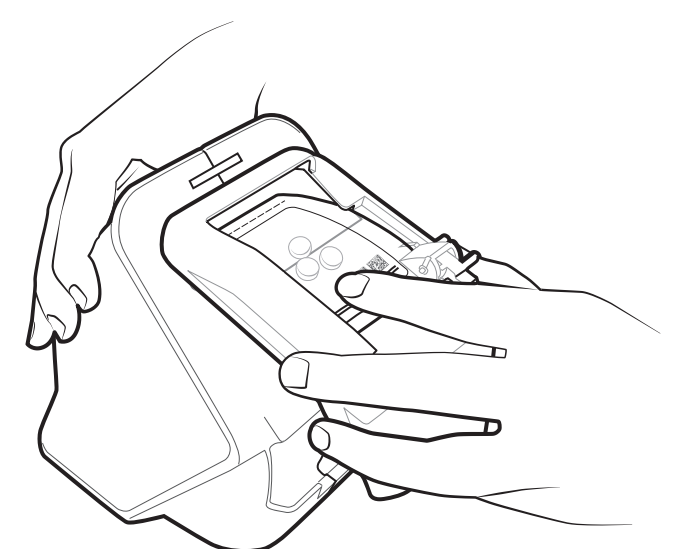

### 13 Secure the top cover into place by pressing down at the front



### 14 Lift the footpad and pull the header medication pouch underneath it

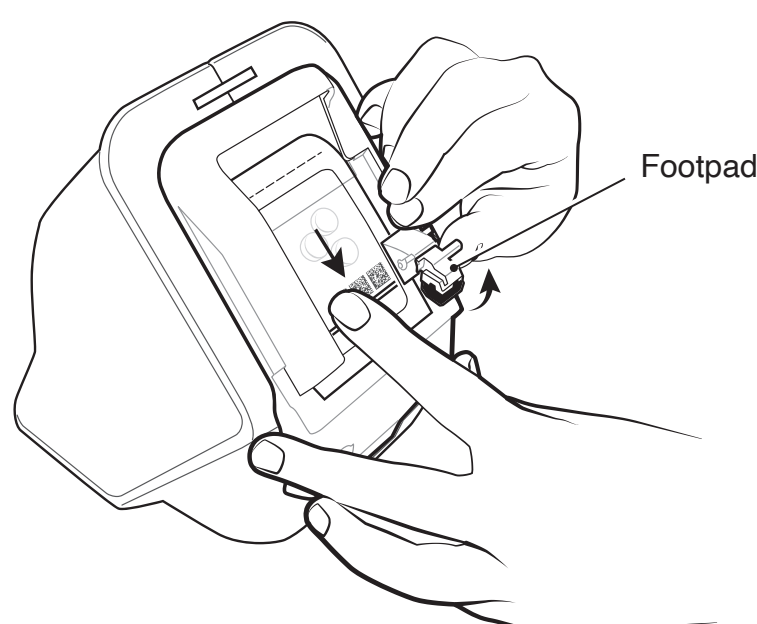

### 15 Make sure the medication pouch is not hanging over the edge of the cartridge

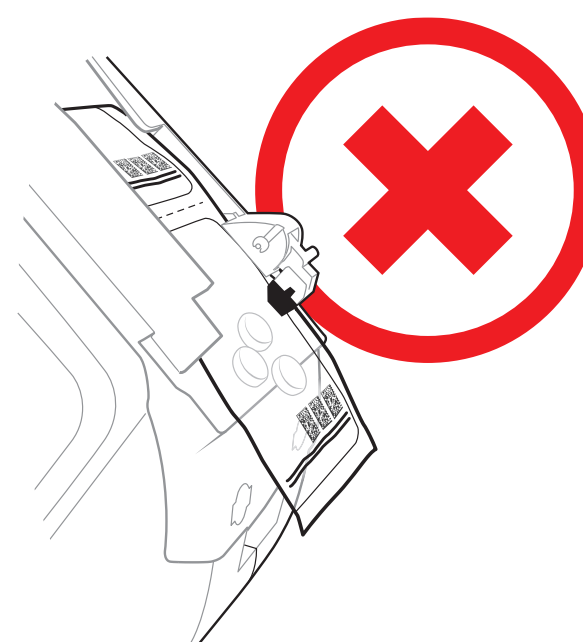

### 16 Ensure the edge of the pouch lies parallel to and even with the edge of the cartridge

